

# TEMA MULTI / TEMA MONO FOR PIPES INNER SURFACE

---

Green Project, thanks to the small dimension of TEMA marking heads, offers a unique solution capable to mark characters on the inner surface of the pipe.

## **Main Marking Features**

Cold and Hot application up to 750 °C

Static (pipe stopped under marking machine)

Marking position: on the inner surface, along the pipe axis or circumferential

Symbols: letters, numbers, special characters (logos), Data Matrix code

Height of symbols from 28 mm to 100 mm, in one or more lines

For TEMA Multi, fonts based on dot matrix: 7, 9 or 12 dots in height

For TEMA Mono, standard and OCR fonts, based on a continuous line, are available

## **System configuration**

Six axes Robot

One TEMA Multi / TEMA Mono marking head

Paint preparation cabinet (including circuit for paint recirculation)

Pneumatic cabinet

Automatic cleaning system

Power and control cabinet

Work cell with safety fence

Control desk with HMI

For hot applications, the system is equipped with a kit for thermal protection



**Green Project**

### Functional features :

Automatic adapting to different pipe dimension and position

Many parameters can be adjusted / selected by the operator via Control Unit, f.i.:

Characters dimension (width, compression, height)

Host connection (Ethernet, Profibus or other common industrial fieldbus)

### Optional functions :

Marking a *Data Matrix* code readable by a standard reader (combined marking / reading function to achieve automatic tracking of coils)

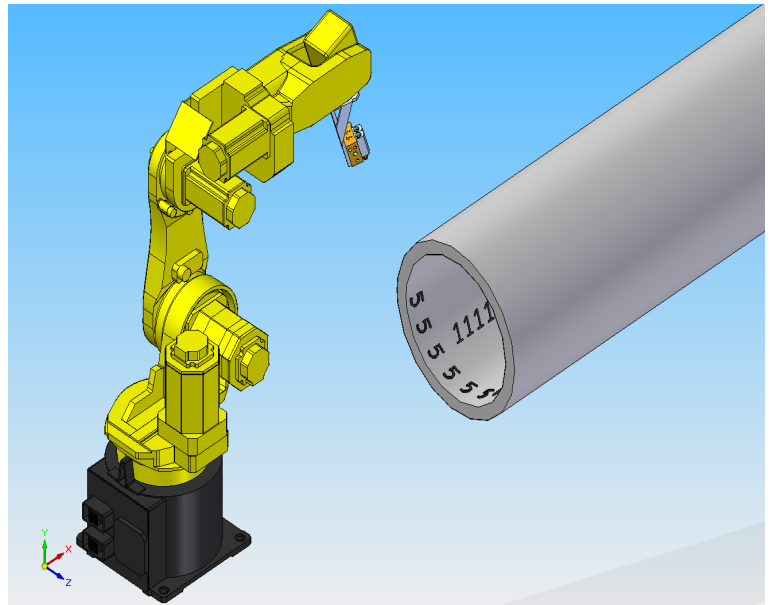

### Paint / Ink features:

#### Type:

cold : paint (solvent or alcohol base),  
ink (MEK or alcohol base)

hot : paint (solvent base)

**Colour:** white (other colours available for cold applications)

**Consumption:** approx. 10 g for 1000 dots (about 60 chars 70mm high)